

 **all in**  
**ONE DAY**



From **delivery**    
to **installation**

**ED EZDOOR**  
CONTRACT SERIES

Fire rated Door &  
Non Fire rated Door

**HORMANN**



\*Against Manufacturing Defects on Door

# Our Presence in India



SHAKTI HÖRMANN BECOMES  
THE FIRST COMPANY IN INDIA TO BE  
GRANTED THE ISI MARK FOR FIRE DOORS

Choose from a pre-selected range of  
standard doors and receive your high  
performance Hormann doors faster than  
ever before.

## BENEFITS TO THE BUYER

- Fire Doors are complaint to NBC 2016 and 100% Tested as per IS 3614 2021
- ISI Marked Doors tested at CBRI Roorkee
- Standard sizes for ease of selection
- 5 years warranty against manufacturing defects
- Complete package of door and hardware in one box
- Easy to handle, store and install
- Choice of RAL colors

## PLACE YOUR ORDER IN 3 EASY STEPS

- 

1 Select your door and hardware configuration
- 

2 Book your order through our partner
- 

3 Make your payment

All warranties are subject to manufacturer's terms and conditions of supply and installation.

Please refer the terms of supply and installation for further details.

\* 5 Years on Door & 1 Year only on Hardware



Colour

Standard colours



Traffic Red

RAL 3020 (01)



Cream

RAL 9001 (02)



Window Grey

RAL 7040 (03)

\* These colours are for illustration only. Please refer to paint chips for colour matching.

Joinery Details

Insulated door

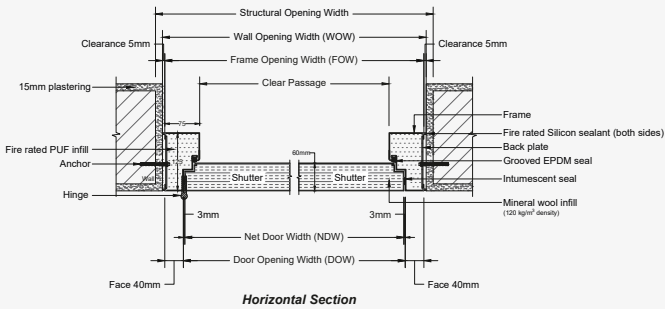

Uninsulated door

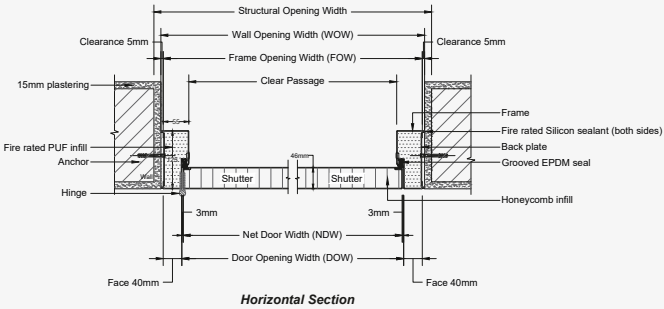

Handing

Application

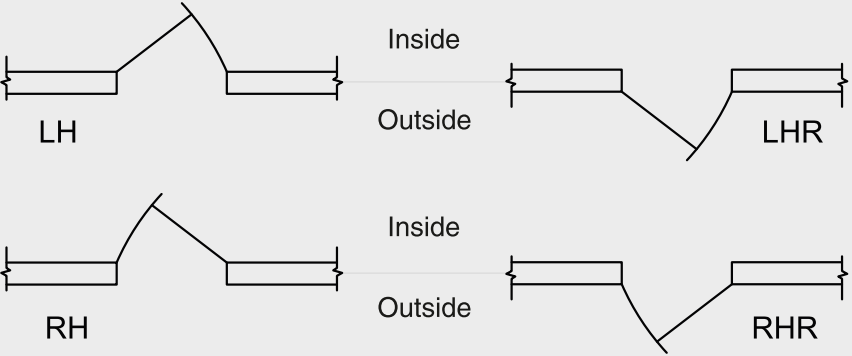

Insulated door

- Exit staircase
- Corridors

Uninsulated door

- Utility door
- Shafts
- Others

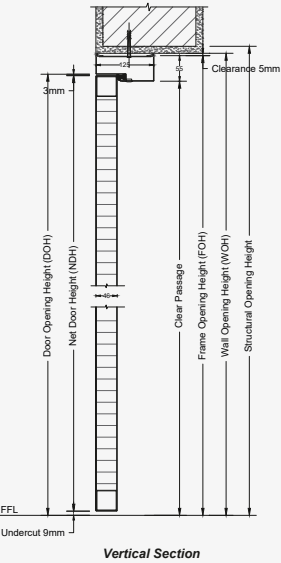
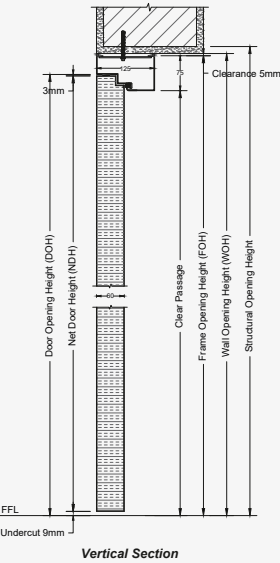



# Insulated Fire Doors



Material	Galvanised steel
Shutter	60 mm
Profile	125 x 75 mm
Frame stop	15 mm
Profile type	Grooved
Assembly	Mitered
Infil	Mineral wool
Undercut	9 mm
Sheet thickness	1.2/1.2 mm

Wall Opening Sizes (WOW X WOH)

- 1000 x 2100 mm
- 1200 x 2100 mm

- 1000 x 2400 mm
- 1200 x 2400 mm

Glass Dimensions

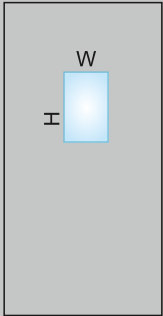

Vision panel 200 x 300 mm



120 min. Integrity, 30 min. Insulation



Fire Rated Insulated Door with Panic Device

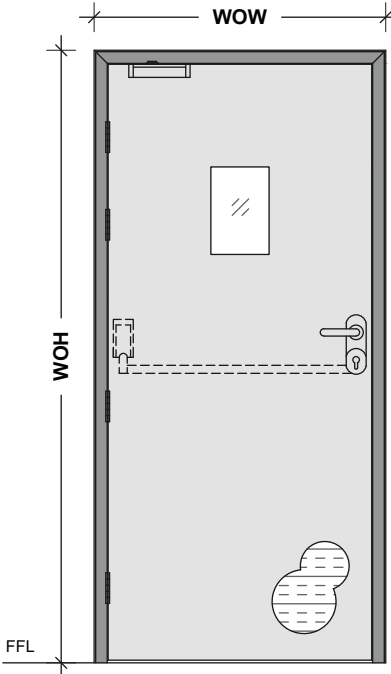

Hardware set - C9 (2100)	
Material Description	Finish
Ball bearing butt hinge, SS304, of size 100 x 75 x 3 mm with screws in SSS - Hörmann	SSS
Single point surface panic latch XDL5760SV, Silver finish - Hörmann	Silver
External lever handle, 1185, with locking arrangement, Silver finish - Hörmann	Silver
Surface door closer 9903 with standard arm, Silver finish - Ryobi	Silver
Clear fire rated glass, 6 mm, for 120 min (200 x 300 mm)	N/A
Gasket for glass fixing, Fire rated 4 mm thick x 13 mm, Black	N/A
Fire door intumescent seal H1515, of size 15x1.5 mm, self-adhesive, Black colour	Black
Fire and smoke seal C421, Black - Hörmann	Black

\* Hardware set - C10 for 2400 mm height (Refer Order Form)

Fire Rated Insulated Door with Mortise Sash Lock

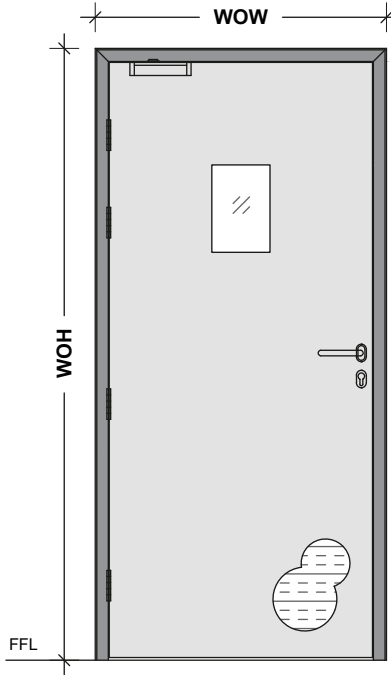

Hardware set - A9 (2100)	
Material Description	Finish
Ball bearing butt hinge, SS304, of size 100 x 75 x 3 mm with screws in SSS - Hörmann	SSS
Mortise sash lock, H11, 55 mm BS, 20 mm sq. forend, SSS - Hörmann/Geze	SSS
Euro profile 5 pin cylinder , 80 mm Key x Key, NP finish. - Hörmann	NP
6 mm Narrow profile escutcheon Hörmann SSS	SSS
Narrow profile lever handle LT101 with ovel rose and escutcheon satin finish - Hörmann	SSS
Surface door closer 9903 with standard arm, Silver finish - Ryobi	Silver
Clear fire rated glass, 6 mm, for 120 min (200 x 300 mm)	N/A
Gasket for glass fixing, Fire rated 4 mm thick x 13 mm, Black	N/A
Fire door intumescent seal H1515, of size 15x1.5 mm, self-adhesive, Black colour	Black
Fire and smoke seal C421, Black - Hörmann	Black

\* Hardware set - A10 for 2400 mm height (Refer Order Form)

WOW - Wall Opening Width  
WOH - Wall Opening Height  
FFL - Finished Floor Level



# Uninsulated Fire Doors



Material	Galvanised steel
Shutter	46 mm
Profile	125 x 55 mm
Frame stop	15 mm
Profile type	Grooved
Assembly	Mitered
Infil	Honeycomb
Undercut	9 mm
Sheet thickness	1.2/1.2 mm

Wall Opening Sizes (WOW X WOH)

- 1000 x 2100 mm
- 1200 x 2100 mm

- 1000 x 2400 mm
- 1200 x 2400 mm

Glass Dimensions

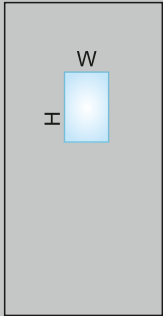

Vision panel 200 x 300 mm



120 min. Integrity only



Fire Rated Un-insulated Door with Panic Device

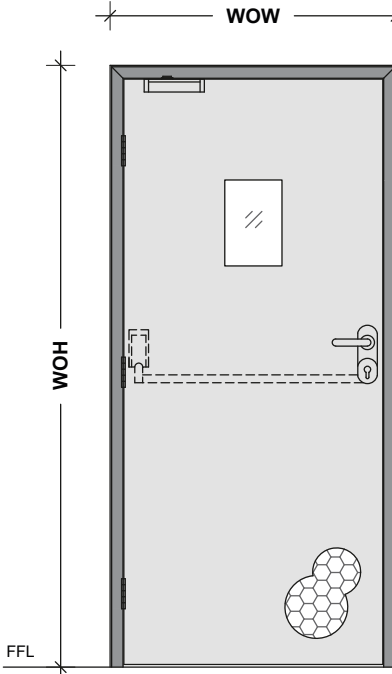

Hardware set - C1 (2100)	
Material Description	Finish
Ball bearing butt hinge, SS304, of size 100 x 75 x 3 mm with screws in SSS - Hörmann	SSS
Single point surface panic latch XDL5760SV, Silver finish - Hörmann	Silver
External lever handle, 1185, with locking arrangement, Silver finish - Hörmann	Silver
Surface door closer 9903 with standard arm, Silver finish - Ryobi	Silver
Clear fire rated glass, 6 mm, for 120 min (200 x 300 mm)	N/A
Gasket for glass fixing, Fire rated 4 mm thick x 13 mm, Black	Black
Fire and smoke seal C421, Black - Hörmann	Black

\* Hardware set - C2 for 2400 mm height (Refer Order Form)

WOW - Wall Opening Width  
WOH - Wall Opening Height  
FFL - Finished Floor Level





# Uninsulated Fire Doors



Material	Galvanised steel
Shutter	46 mm
Profile	125 x 55 mm
Frame stop	15 mm
Profile type	Grooved
Assembly	Mitered
Infil	Honeycomb
Undercut	9 mm
Sheet thickness	1.2/1.2 mm

Wall Opening Sizes (WOW X WOH)

- 1000 x 2100 mm
- 1200 x 2100 mm

- 1000 x 2400 mm
- 1200 x 2400 mm

Glass Dimensions

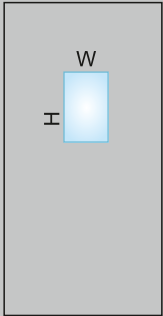

Vision panel 200 x 300 mm



120 min. Integrity only



Fire Rated Un-insulated Door with Mortise Sash Lock

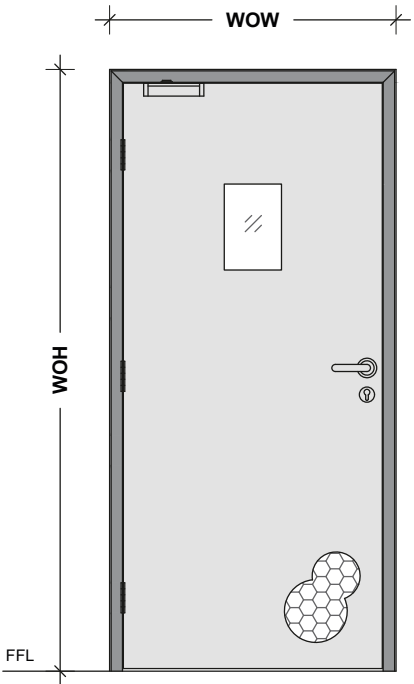

Hardware set - A1 (2100)

Material Description	Finish
Ball bearing butt hinge, SS304, of size 100 x 75 x 3 mm with screws in SSS - Hörmann	SSS
Mortise sash lock, H11, 55 mm BS, 20 mm sq. forend, SSS - Hörmann/Geze	SSS
Euro profile 5 pin cylinder 5702, 70 mm Key x Key, NP finish. - Hörmann	NP
Lever handle LT 001, 19 Dia with roses & escutcheion, SS 304, SSS finish. - Hörmann	SSS
Surface door closer 9903 with standard arm, Silver finish - Ryobi	Silver
Clear fire rated glass, 6 mm, for 120 min (200 x 300 mm)	N/A
Gasket for glass fixing, Fire rated 4 mm thick x 13 mm, Black	Black
Fire and smoke seal C421, Black - Hörmann	Black

\* Hardware set - A2 for 2400 mm height (Refer Order Form)

Fire Rated Un-insulated Door with Mortise Dead Lock

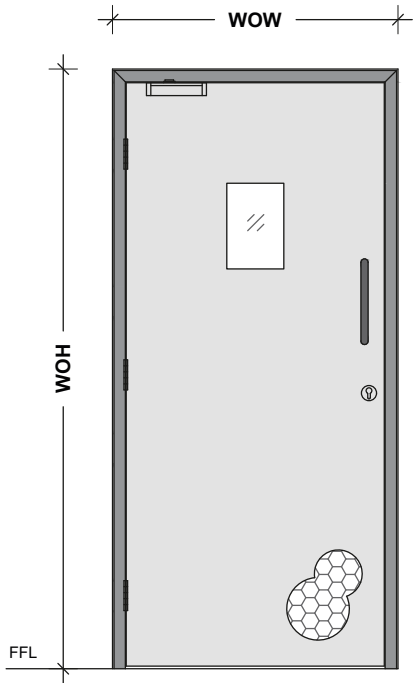

Hardware set - B1 (2100)

Material Description	Finish
Ball bearing butt hinge, SS304, of size 100 x 75 x 3 mm with screws in SSS - Hörmann	SSS
Mortise dead lock, inc strike H4, 55mm BS, 20 mm sq.forend SSS finish - Hörmann / Geze	SSS
Euro profile 5 pin cylinder 5702, 70 mm Key x Key, NP finish. - Hörmann	NP
Pull handle D type, 22 dia, CTC 300 mm, back to back, with extended spindle, SS 304, SSS Finish - Hörmann	SSS
Surface door closer 9903 with standard arm, Silver finish - Ryobi	Silver
Clear fire rated glass, 6 mm, for 120 min (200 x 300 mm)	N/A
Gasket for glass fixing, Fire rated 4 mm thick x 13 mm, Black	Black
Fire and smoke seal C421, Black - Hörmann	Black

\* Hardware set - B2 for 2400 mm height (Refer Order Form)

WOW - Wall Opening Width  
WOH - Wall Opening Height  
FFL - Finished Floor Level



# Multipurpose Doors

Material	Galvanised steel
Shutter	46 mm
Profile	125 x 55 mm
Frame stop	15 mm
Profile type	Grooved
Assembly	Mitered
Infil	Honeycomb
Undercut	9 mm
Sheet thickness	1.2/0.8 mm

Wall Opening Sizes (WOW X WOH)

- 1000 x 2100 mm
- 1200 x 2100 mm

- 1000 x 2400 mm
- 1200 x 2400 mm

Glass Dimensions

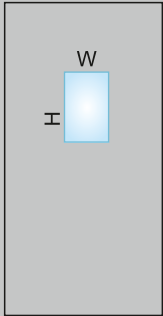

Vision panel 200 x 300 mm



Non-Fire rated door



Multipurpose Door with Mortise Sash Lock

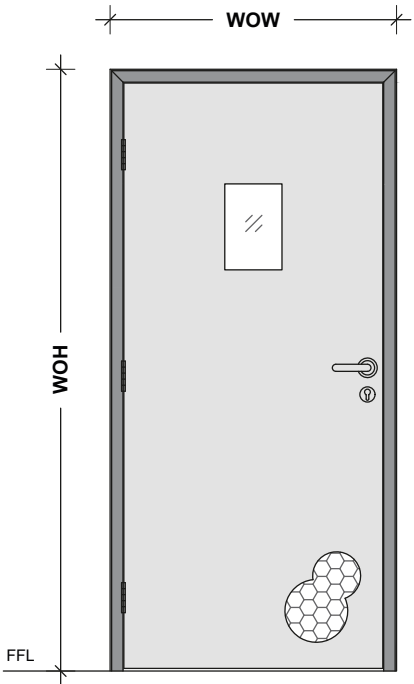

Hardware set - A3 (2100)

Material Description	Finish
Ball bearing butt hinge, SS304, of size 100 x 75 x 3 mm with screws in SSS - Hörmann	SSS
Mortise sash lock, H11, 55 mm BS, 20 mm sq. forend, SSS - Hörmann/Geze	SSS
Euro profile 5 pin cylinder 5702, 70 mm Key x Key, NP finish. - Hörmann	NP
Lever handle LT 001, 19 Dia with roses & escutcheion, SS 304, SSS finish. - Hörmann	SSS
Clear non fire rated toughened glass, 5 mm thick (200 x 300 mm)	N/A
Foam tape for glass fixing, single adhesive 4 mm thick x 12.5 mm, Black	Black
Non-fire rated seal for grooved frame profile C420 PVC Grey - Hörmann	Grey

\* Hardware set - A4 for 2400 mm height (Refer Order Form)

Multipurpose Door with Mortise Dead Lock

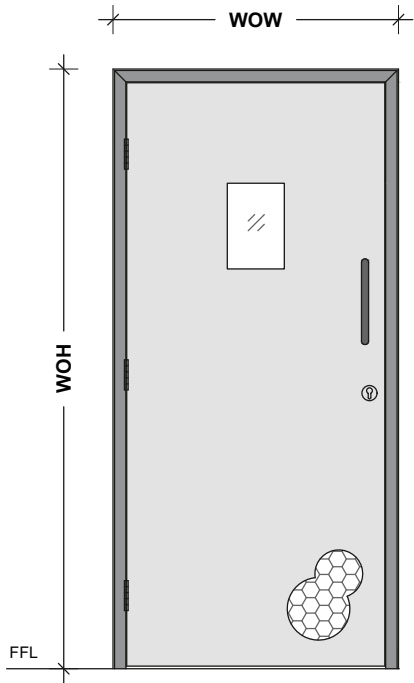

Hardware set - B3 (2100)

Material Description	Finish
Ball bearing butt hinge, SS304, of size 100 x 75 x 3 mm with screws in SSS - Hörmann	SSS
Mortise dead lock, inc strike H4, 55mm BS, 20 mm sq.forend SSS finish - Hörmann / Geze	SSS
Euro profile 5 pin cylinder 5702, 70 mm Key x Key, NP finish. - Hörmann	NP
Pull handle D type, 22 dia, CTC 300 mm, back to back, with extended spindle, SS 304, SSS Finish - Hörmann	SSS
Clear non fire rated toughened glass, 5 mm thick (200 x 300 mm)	N/A
Foam tape for glass fixing, single adhesive 4 mm thick x 12.5 mm, Black	Black
Non-fire rated seal for grooved frame profile C420 PVC Grey - Hörmann	Grey

\* Hardware set - B4 for 2400 mm height (Refer Order Form)

WOW - Wall Opening Width  
WOH - Wall Opening Height  
FFL - Finished Floor Level



Stainless Steel Ball Bearing  
Butt Hinge 100 x 75 x 3 mm



Mortise Sashlock H11  
BS 55 mm



Mortise Deadbolt H4  
BS 55 mm



Panic Device XDL 5760 SV  
Single Point



Euro Profile Cylinder  
with Both Side Key



Stainless Steel  
Lever Handle LT001



D Type Handle



Panic device External Trim



Ryobi Door closer



Escutcheon ES 001



Narrow Lever Handle LT101



Oval Escutcheon

Choose your requirement

Door type	WO size std door (mm)
FDIN - Fire door Insulated	1021 - 1000 x 2100
FD - Fire door Uninsulated	1221 - 1200 x 2100
MPD - General door	1024 - 1000 x 2400
	1224 - 1200 x 2400

Hardware sets	FDIN		FD		MPD	
	2100	2400	2100	2400	2100	2400
Panic device	C9	C10	C1	C2	x	x
Mortise Sash lock	A9	A10	A1	A2	A3	A4
Mortise Dead lock	x	x	B1	B2	B3	B4

Vision Panel	Handing	Colour
00 - Without vision panel	11 - Right Hand (RH)	Standard
01 - With vision panel	12 - Left Hand (LH)	01 - RAL 3020 Traffic Red
	13 - Right hand reverse (RHR)	02 - RAL 9001 Cream White
	14 - Left hand reverse (LHR)	06 - RAL 7040 Window Grey

Note: all panic device handing will be either LHR/RHR

Example: if you want a fire door of size 1200 x 2400 mm, insulated with panic device and vision panel handing left hand reverse in RAL 3020 you can order either by giving the product code or SAP reference

Product code shall be - **FDIN-1224-C10-01-14-RAL Code & the quantity**

(INR)						
S.no	Product Code	Handing	Colour	SAP code	Qty	Total
1	FDIN1224C1001	14	RAL Code			

Total qty / Basic value \_\_\_\_\_  
Packing \_\_\_\_\_  
Transportation \_\_\_\_\_

GST @ 18% on basic value, packing & transportation  
(or as applicable at the time of dispatch)

Grand total in INR \_\_\_\_\_

Ship to:	Bill to:

GSTN No:



**Hörmann: Quality without compromise**



Hörmann KG Amshausen, Germany



Hörmann KG Antriebstechnik, Germany



Hörmann KG Brandis, Germany



Hörmann KG Brockhagen, Germany



Hörmann KG Dissen, Germany



Hörmann KG Eckelhausen, Germany



Hörmann KG Freisen, Germany



Hörmann KG Ichtershausen, Germany



Hörmann KG Werne, Germany



Hörmann Alkmaar B.V., Netherlands



Hörmann Legnica Sp. z o.o., Poland



Hörmann Beijing, China



Hörmann Tianjin, China



Hörmann LLC, Montgomery IL, USA



Hörmann Flexon LLC, Burgettstown PA, USA



Shakti Hormann, India



Hyderabad Plant, India



Jaipur Plant, India

**RESIDENTIAL DOORS | COMMERCIAL DOORS | INDUSTRIAL DOORS | LOADING BAY TECHNOLOGY | PERIMETER CONTROL SYSTEMS**



**Shakti Hormann Pvt. Ltd.**

H.No.2-67/1, Gagillapur, Dundigal Municipality,  
Medchal (Malkajgiri) District – 500 043.  
Telangana, India

E: [sales@shaktihormann.com](mailto:sales@shaktihormann.com)  
[www.shaktihormann.com](http://www.shaktihormann.com)

☎ **+91 81422 36677**



Platinum Rated Green Facility

**HÖRMANN**  
An ISO 9001:2015, ISO 14001:2015 and  
ISO 45001:2018 certified company